

High Power PM 1064nm Circulator



Features

- High Isolation.
- Low Insertion Loss
- Compact Size
- High ER

Application

- Optical Fiber Amplifier
- Metro Area Network
- Wavelength Add/Drop
- Dispersion Compensation



Performance Specifications

Parameters	Specifications	Unit
Directivity	Port 1 to Port 2 to Port 3	-
Center Wavelength(λ_c)	1053-1075nm	nm
ISOLATION	30 dB	nm
Typical Insertion Loss@23℃	≤1.0	dB
INSERTION LOSS	1.3-1.9 dB	dB
Min Isolation @23℃	≥22	dB
Return Loss	≥50	dB
POLARIZATION EXTINCTION RATIO	>20	dB
Max Optical Power(CW)	5	W
Max Peak Power for ns Pulse	10	KW
DIRECTIVITY (1-3)	40 dB	N
Operating Temperature	10-50 C	℃
Storage Temperature	-10-65 C	℃
Fiber Type	PM 980 Panda Fiber	/

* The temperature measurement environment is at 23℃

**If the connection head is increased, the insertion loss increases by 0.3dB and the return loss decreases by 5dB, which is reduced by 2dB for the protection product

Mechanical Dimensions

Hirundo Optics Inc

Factory: 2nd Floor, Building 6, #16 Xinfa Road, Southern Cable Industrial Park, Rongli Ronggui Street, Shunde District, Foshan city, Guangdong 528305 China
Tel: 0757-26619220 Email: info@hirundo-link.com Website: <https://www.hirundo-link.com>

High Power PM 1064nm Circulator

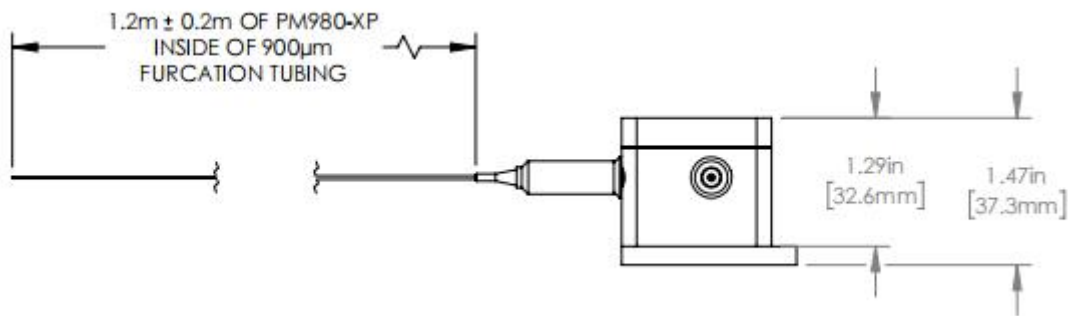
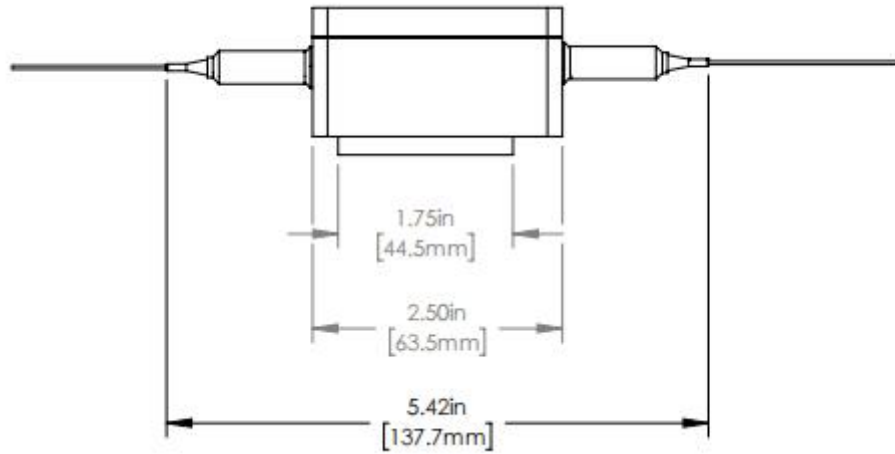

Hirundo Optics Inc

Factory: 2nd Floor, Building 6, #16 Xinfu Road, Southern Cable Industrial Park, Rongli Ronggui Street, Shunde District, Foshan city, Guangdong 528305 China
Tel: 0757-26619220 Email: info@hirundo-link.com Website: <https://www.hirundo-link.com>